

Pine Hill Charcoal Kilns

not located on 6/23/00

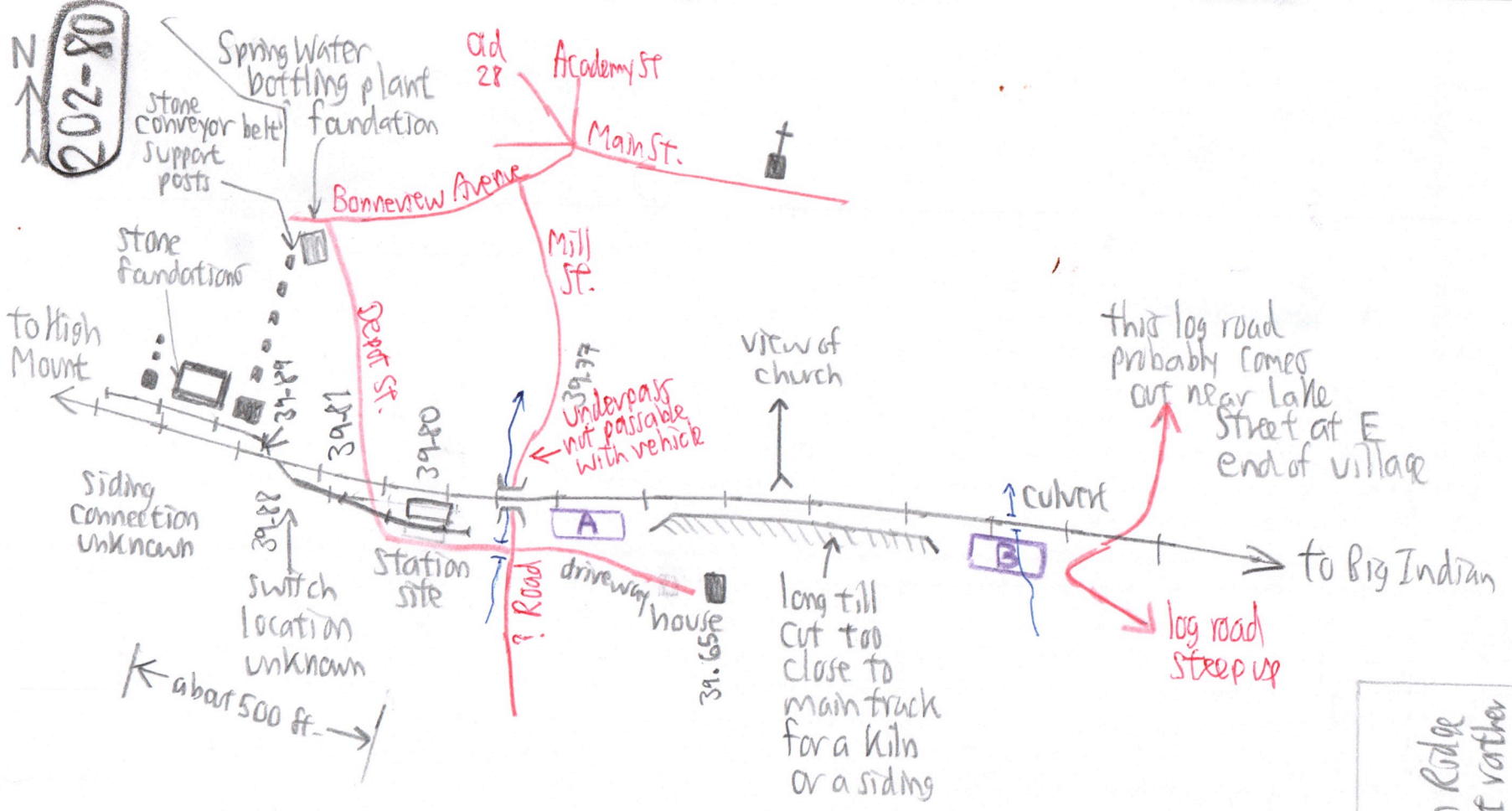

Revisit BEFORE leaf out!!

A and **B** are possible sites for the beehive kilns shown in Schile's drawing because there is room along the main track for an industry and/or siding. But, no evidence of any foundations or other industrial relics remains. Vegetation is very thick in places the ground is springy wet. No charcoal is anywhere with t^le spade probes. Could the kiln be
 ① closer to the station ② further east along the main, or ③ not trackside

at all but upon the hill.
 The charcoal from atop Banetson Ridge most likely did not come here but rather was hauled to Big Indian depot via the Lost Cove Trail.